

FAQ

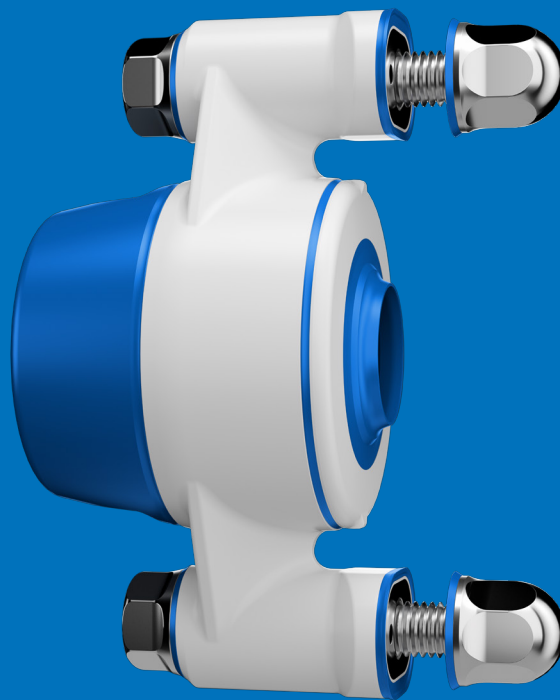

Certified Hygienic Bearing houses

Certified Hygienic Bearing houses

Q1: What makes NGI's hygienic bearing houses unique?

A: NGI certified hygienic bearing houses are made of reinforced polymer and designed for easy cleaning access from all angles. They are lubricated for life, meaning there is minimal maintenance and no need to pause the line to relubricate.

Q2: What benefits do they have over other types of bearing houses?

A: With more efficient cleaning cycles, cleaning costs decrease across the board: labor, water, and detergent. It increases uptime and extends the life of the bearing, all of which have a direct impact on yield.

Also, the NGI bearing housing is lubricated for life- and not only in theory. Because the bearing insert is fully protected inside the water-tight housing, the grease is not washed out of the ball bearing. This saves maintenance costs and prevents mechanical failure caused by insufficient lubrication.

Q3: What does hygienic design mean in a bearing house?

A: Hygienic design generally means constructed to guarantee easy and efficient cleaning. Every NGI hygienic bearing housing is made with food-safe materials, fully sealed against contamination, and designed to prevent water ingress and survive aggressive washdowns.

→ [Read more about reducing contamination risks online on our website](#)

Q4: Which models are available?

A: We currently have five housing types available for a wide range of applications:

1. XB2FC - 2-bolt parallel housing
2. XB3FC – 3-bolt housing for added stability
3. XB4FC – 4-bolt housing for maximum strength
4. XBPBC – Perpendicular flange housing (pillow block)
5. XBTBC – Threaded bolt-on flange (tapped base)

All models can be equipped with stainless steel ball bearing or hybrid ceramic ball bearing inserts with either set screws or eccentric collar.

→ [Read more about choosing the right bearing house online on our website](#)

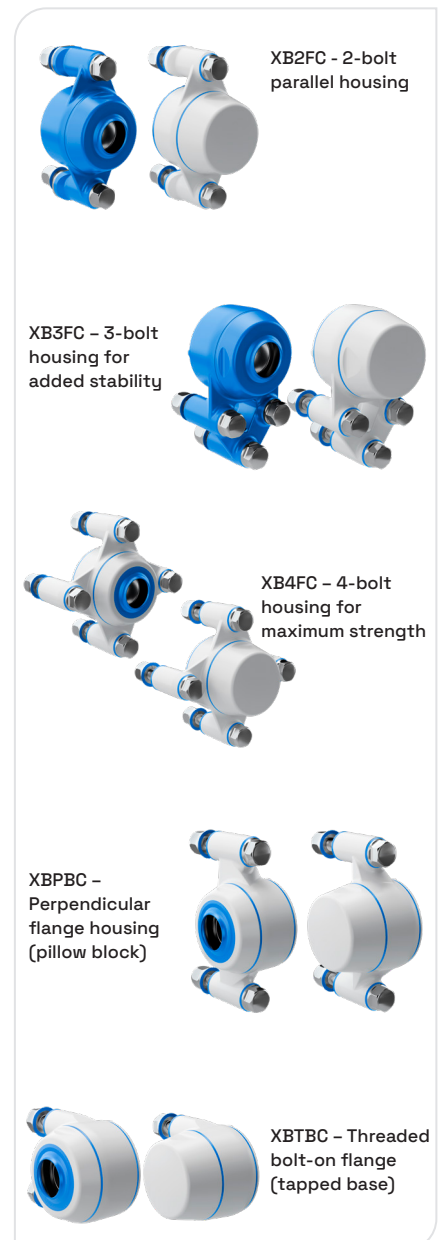

Certified Hygienic Bearing houses

Q5: Can they integrate into existing machines?

A: The mounting pattern is identical to existing bearing houses, so replacement is easy and straightforward. The houses are suitable for shaft sizes between 20 mm and 40 mm in metric and ¾ inch to 1½ inch in imperial.

Q6: What certifications do these bearing houses have?

A: They are IP69K-certified and the only ones in the world certified by USDA, EHEDG and 3-A design principles.

Q7: What role does grease play in fretting prevention?

A: Fretting is a type of wear caused by repeated micro-movement between the shaft and the inner ring. The most effective way to prevent fretting is to use a high-viscosity anti-fretting paste during installation.

Even though NGI's bearings don't require lubrication in operation, that initial layer of grease at mounting acts as a cushion between the shaft and bearing. It fills microscopic surface imperfections and absorbs some of the vibration that would otherwise lead to wear.

→ [Read more about fretting prevention online on our website](#)

Q8: Is lubrication-free the same as maintenance-free?

A: This is a common misunderstanding. NGI's bearings are designed to run without grease or oil under normal operating conditions. However, this doesn't mean that installation can be treated casually.

Think of grease during installation as a temporary protection, like using gloves during food handling. You might not need them during packaging, but if you skip them during preparation, problems begin early.

Q9: What sort of support does NGI offer?

A: NGI is committed to customer collaboration and innovation. We provide comprehensive support, including:

- Technical expertise and guidance
- Training on installation and operation
- Assistance with selecting the bearing housing for your application
- Ongoing support to ensure smooth operation and address any concerns



Read more
about
certified hygienic
bearing houses